

CLAMP

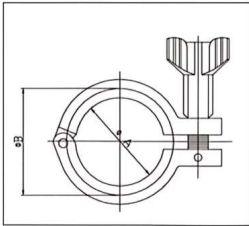

Size	A	B	Ferrule OD
1/2"	12.5	25	25
3/4"	26.1	34	34
1"	27.8	37	50.5
1-1/2"	44.4	53.6	50.5
2"	57.8	67	64
2 1/2"	71.4	80.6	77.5
3"	84	94.2	91
3 1/2"	99	109.2	106
4"	110	122.2	119
4 1/2"	123	133.2	130
5"	135.5	148*3.5	145
5"	135.5	148*5.6	145
5.5"	145	159	155
6"	155.4	170.4	167
DN150	173	187	183
8"	205	220	217
DN200	223	237	233
10"	258	272	268
12"	307	323	319

High Pressure Clamp

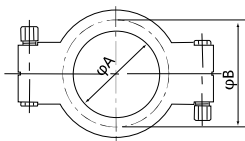

SIZE	ΦA	ΦB
1/2"-3/4"	20	28
1"-1.5"	43.3	52.0
2.0"	56.4	65.5
2.5"	69.5	79.0
3.0"	77.5	92.5
3.5"	102	108
4.0"	108.8	120.5
4.5"	124	133
5.0"	135.5	148
5.5"	149	158
6.0"	158	170
DN150	177	187
8.0"	206	220
DN200	232	237
10"	258	272.8
11"	282	289
12"	309	327.6

Ferrule

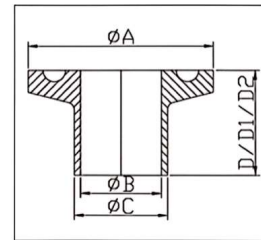

Size	A	B	C	D1	D	D2
1/2"	25	9.7	12.7	12.7	21.5	28.6
3/4"	34	16	19.1	12.7	21.5	28.6
1"	50.5	22.4	25.4	12.7	21.5	28.6
1 1/4"	50.5	28.8	32	12.7	21.5	28.6
1 1/2"	50.5	35.1	38.1	12.7	21.5	28.6
2"	64	47.8	50.8	12.7	21.5	28.6
2 1/2"	77.5	59.5	63.5	12.7	21.5	28.6
3"	91	72.2	76.2	12.7	21.5	28.6
4"	119	97.6	101.6	15.9	21.5	28.6
6"	183	153	159	21.5	21.5	38.1
8"	217	197.2	203.2	21.5	21.5	38.1
10"	268	248	254	21.5	21.5	38.1
12"	319	299	304.8	21.5		38.1

3A Ferrule

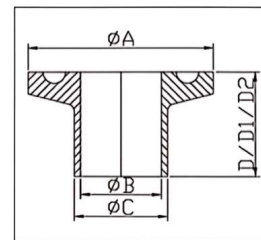

Size	A	B	C	D1	D	D2
1/2"	25.2	9.4	12.7	12.7	21.5	28.6
3/4"	25.2	15.7	19.05	12.7	21.5	28.6
1"	50.5	22.1	25.4	12.7	21.5	28.6
1 1/4"	50.5	28.5	31.8	12.7	21.5	28.6
1 1/2"	50.5	34.8	38.1	12.7	21.5	28.6
2"	64	47.5	50.8	12.7	21.5	28.6
2 1/2"	77.5	60.2	63.5	12.7	21.5	28.6
3"	91	72.9	76.2	12.7	21.5	28.6
4"	119	97.33	101.6	15.9	21.5	28.6
6"	166.88	146.8	152.4	21.5	21.5	38.1
8"	217.7	197.6	203.2	21.5	21.5	38.1
10"	268.5	247.19	254	21.5	21.5	38.1
12"	319	297.99	304.8	21.5	21.5	38.1

SMS Union(Single Step)



Size	A	B	C	L
3/4"	16	20	28	17
1"	22	25	28	19
1 1/4"	30	32	33	20
1 1/2"	35	38	33	20
2"	48	51	34	22
2 1/2"	60	63	40	23
3"	72	76	40	24
4"	98	101	40	26

SMS Liner(Double Step)

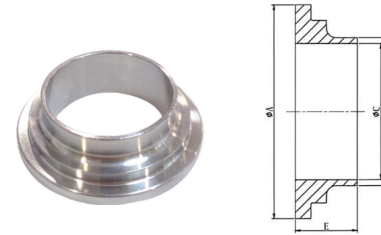

SIZE	A	B	I
25	35.5	22.4	15.5
38	55	35.1	16
51	65	47.8	17
63	80	59.5	19
76	93	72.2	19
102	127	97.6	19

SMS Union (Double Step)

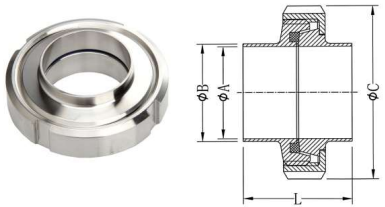

Size	A	B	C	L
1"	22	25	33	19
1 1/4"	30	32	33	19
1 1/2"	35	38	38	19
2"	48	51	40	22
2 1/2"	58	63	40	23
3"	72	76	40	24
4"	98	101	47	26

SMS Liner(Single Step)

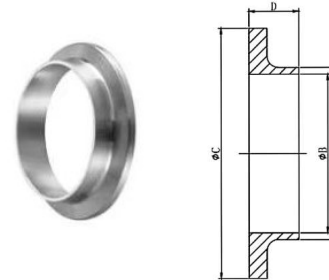

SIZE	A	B	C	D
19	19	16	30	11
25	25.4	22.4	35.4	11
32	31.8	28.8	43.5	12
38	38.1	35.1	55.4	11
45	45	42	55.4	11
51	50.8	47.8	65.4	11
57	57	53	65.4	12
63	63.5	59.5	80.4	12
76	76.2	72.2	93.4	12
89	89	85	105.4	15
102	101.6	97.6	120.4	12

DIN11851 Union

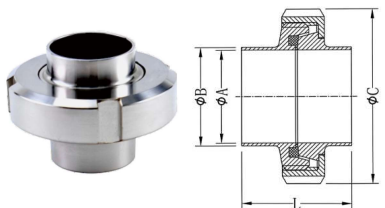

Size	A	B	C	L
DN10	9	12	38	35
DN15	15	18	44	35
DN20	19	22	54	37
DN25	25	28	63	45
DN32	31	34	70	51
DN40	37	40	78	53
DN50	49	52	92	57
DN65	66	70	112	65
DN80	81	85	127	75
DN100	100	104	148	89
DN125	125	129	178	69
DN150	150	154	210	75

DIN 11851 Liner

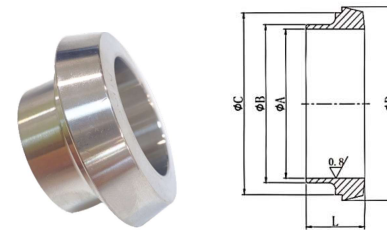

SIZE	A	B	D	I	L
DN10	9	12	18	22.2	17
DN15	15	18	24	28.2	17
DN20	19	22	30	36.3	18
DN25	25	28	35	44	22
DN32	31	34	41	50	25
DN40	37	40	48	56	26
DN50	49	52	61	68	28
DN65	66	70	79	86	32
DN80	81	85	93	100	37
DN100	100	104	114	121	44
DN125	125	129	137	150	34
DN150	150	154	163	176	37

SMS Welding Male

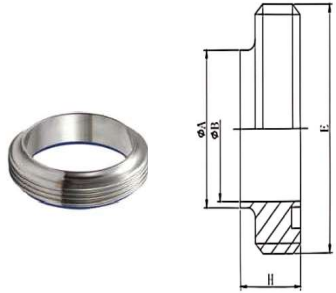

SIZE	A	B	I	I	
19	3/4"	19	16	RD34.5X1/6	15
25	1"	25.4	22.4	RD40X1/6	15
32	1-1/4"	31.8	28.8	RD48X1/6	18
38	1-1/2"	38.1	35.1	RD60X1/6	20
45	1-3/4"	45	42	RD60X1/6	21
51	2"	50.8	47.8	RD70X1/6	20
57	2-1/4"	57	53	RD70X1/6	21
63	2-1/2"	63.5	59.5	RD85X1/6	24
76	3"	76.2	72.2	RD98X1/6	24
89	3-1/2"	89	85	RD1101/6	26
102	4"	101.6	97.6	RD125X1/6	25
102	4"	101.6	97.6	RD132X1/6	35

SMS Nut

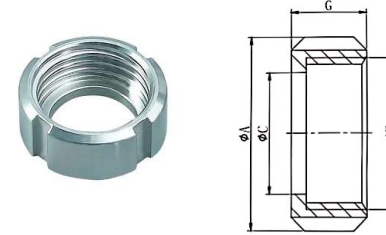

SIZE	A	C	E	G	
19	3/4"	45	26	RD34.5X1/6	18
25	1"	51	32	RD40X1/6	20
32	1-1/4"	60	40	RD48X1/6	22
38	1-1/2"	74	48	RD60X1/6	25
45	13/4"	74	48	RD60X1/6	25
51	2"	84	60.5	RD70X1/6	26
57	21/4"	84	60.5	RD70x1/6	26
63	2-1/2"	100	74	RD85X1/6	30
76	3"	114	87	RD98X1/6	32
89	31/2"	125	94	RD110X1/6	28
102	4"	138	113	RD125X1/6	29
102	4"	154	117	RD132X1/6	45

DIN 11851 Welding Male

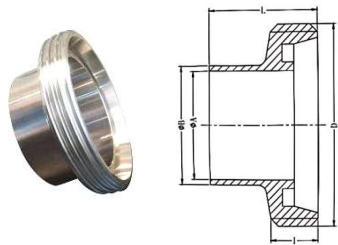

SIZE	A	B	D	I	L
DN10	9	12	RD28 × 1/8	12	21
DN15	15	18	RD34 × 1/8	12	21
DN20	19	22	RD44 × 1/6	14	24
DN25	25	28	RD52 × 1/6	14	29
DN32	31	34	RD58 × 1/6	14	32
DN40	37	40	RD65 × 1/6	14	33
DN50	49	52	RD78 × 1/6	14	35
DN65	66	70	RD95 × 1/6	16	40
DN80	81	85	RD110 × 1/4	20	45
DN100	100	104	RD130 × 1/4	20	54
DN125	125	129	RD160 × 1/4	24	46
DN150	150	154	RD190 × 1/4	30	50

DIN 11851 Nut

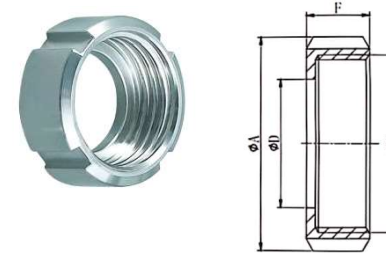

SIZE	A	B	D	F
DN10	38	RD28X1/8	19	18
DN15	44	RD34X1/8	25	18
DN20	54	RD44X1/6	31	21
DN25	63	RD52X1/6	36	21
DN32	70	RD58X1/6	42	21
DN40	78	RD65X1/6	49	21
DN50	92	RD78X1/6	62	22
DN65	112	RD95X1/6	80	25
DN80	127	RD110X1/4	94	30
DN100	148	RD130X1/4	115	31
DN125	178	RD160X1/4	138	35
DN150	210	RD190X1/4	164	40

Thread Rotary Cleaning Ball

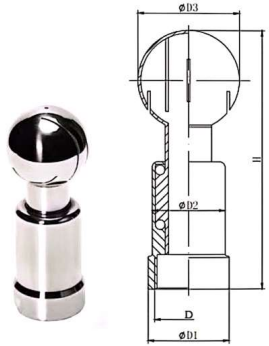

Size	D	D1	D2	D3	H
DN15	G1/2	32	32	38	105
DN20	G3/4	34	32	38	105
DN20	G3/4	34	32	53	105
DN25	G1	42	38	53	138
DN32	G1 1/4	48	38	63	152
DN40	1 1/2	54	48	63	155
DN50	2	65	57	76	169
DN65	G2 1/2	85	57	91	185
DN80	G3	/	/	100	/
DN100	G4	/	/	120	/

Sight Glass

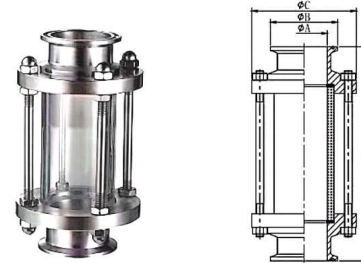

Size	A	B	C	H
19	16	50.5	79	154
25	22.4	50.5	79	154
32	28.8	50.5	79	160
38	35.1	50.5	79	160
45	42	64	88	162
51	47.8	64	100	162
57	53	77.5	106	162
63	59.5	77.5	115	162
76	72.2	91	127	161
89	84.9	106	140	162
102	97.6	119	156	167

Tc Rotary Cleaning Ball



Size	D	D3	H
19	38	50.5	110
25	38	50.5	140
32	53	50.5	140
38	53	50.5	143.5
51	63	64	154
63	76	77.5	170
76	100	91	195
89	120	106	230

Gasket / Seal (Silicone / PTFE / Teflon)



Size	A	B	C
25 OD	25	21	9
25 OD	25	21	16
34 OD	34	27	10
34 OD	34	27	16
34 OD	34	27	19
40 OD	40	32	19
40 OD	40	32	25
19	50.5	44	17
25	50.5	44	22
32	50.5	44	29
38	50.5	44	35
45	64	57	42
51	64	57	48
57	77.5	70	53
63	77.5	70	60
76	91	84	72
89	106	98	85
102	119	110	98
108	119	110	104
114	130	119	111
133	145	135	125
140	155	145	135
154	168	156	148
159	183	170	159
183	200	190	175
204	217	208	198
219	233	224	215

Bolt Rotary Cleaning Ball

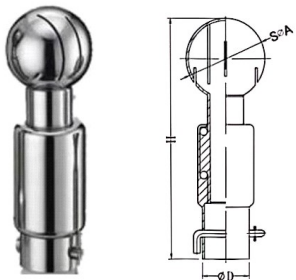

Size	D	H	A
19	19	108	38
25	25.4	143	53
32	31.8	148	53
38	38.1	155	63
51	50.8	185	76

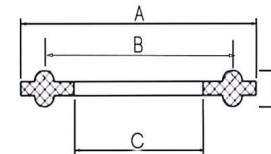

Weld Butterfly Valve (Small body)

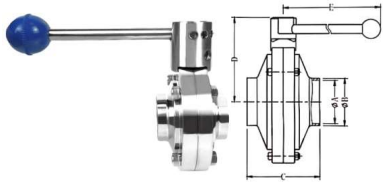

Size	A	B	C	D	E
19	20	20	48.5	70	126.5
25	25.4	25.4	43.1	64.5	126.5
38	35	38	43	70	126
51	47.8	50.8	48	77.5	125.5
63	59.5	63.5	50	84.5	126
76	72.2	76.2	50	93	127
102	97.6	101.6	50	105	127.5
19	16	20	52	67.5	125.5
25	22.4	25.4	52	68	126.5
32	29	32	52	71	127
38	35.1	38.1	52	71	126.5
51	47.8	50.8	52	77.5	125
63	59.5	63.5	54	87.5	143
76	72.2	76.2	56.3	94	137.5
102	97.6	101.6	60	108	160

Weld Butterfly (Regular body)

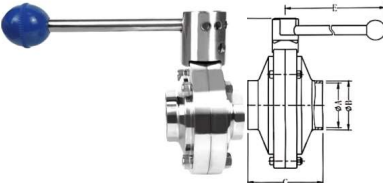

Size	A	B	C	D	E
19	16	20	47	70	127.5
25	22.4	25.4	47	70.5	126
32	28.8	31.8	47	70.5	126
38	35.1	38.1	47	70.5	126
51	47.8	50.8	52	80	125
63	59.5	63.5	54	88.3	135.3
76	72.2	76.2	56	92.2	136
102	97.6	101.6	60	107	160

DIN Weld Butterfly valve

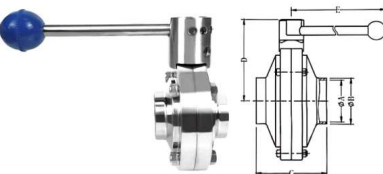

Size	A	B	C	E
DN20	18.5	22	50.1	70
DN25	25	28	50.4	70.5
DN32	31	34	50.1	74
DN40	37	40	50.1	75.1
DN50	49	52	52	85
DN65	66	70	51.2	100
DN80	81	85	58	103.5
DN100	100	104	64	112.5

Ferrule Type Butterfly Valve (Small body)

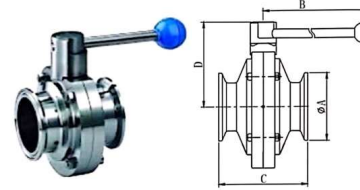

Size	A	B	C	D
19	50.5	127	56	66
25	50.5	130	56	66
32	50.5	125.5	58	66
38	50.5	125.5	58	70
51	64	125.5	58	77
63	77.5	125.5	62	82
76	91	125.5	62	92
102	119	130	62	105

Ferrule Type Butterfly Valve (Regular body)

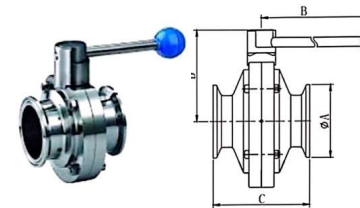

Size	A	B	C	D
32	50.5	127	70	71.5
38	50.5	127	70	71.5
51	64	127	74	79
63	77.5	127	76	88.5
76	91	137	78	92.5
102	119	160	85	107
19	50.5	125	66	66
25	50.5	127	66	66
38	50.5	127	66	70
51	64	127	70	77
63	77.5	137	76	86
76	91	145	76	93
102	119	157	86	107

SMS Thread Butterfly Valve

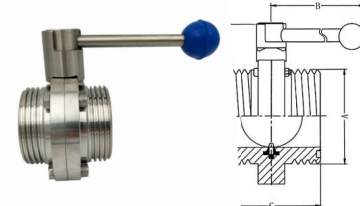

Size	A	B	C	E
19	RD36x1/8	135	68	68
25	RD40x1/6	127	70	71.5
32	RD48x1/6	127	70	71.5
38	RD60x1/6	127	70	71.5
51	RD70x1/6	127	74	79
63	RD85x1/6	137	80	88
76	RD98x1/6	137	84	92
89	RD110x1/6	161	86	110
102	RD125x1/6	161	88	110

Ferrule Type Check Valve

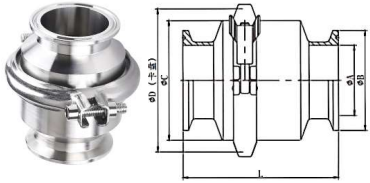

Size	A	B	C	D	L
19	16	50.5	50.8	64	85
25	22.4	50.5	64	77.5	95
32	28.8	50.5	64	77.5	95
38	35.1	50.5	64	77.5	95
45	42	64	65	77.5	98
51	47.8	64	75	91	101
57	53	77.5	76	91	111
63	59.5	77.5	92	106	120
76	72.2	91	104	119	128
89	84.9	106	115	130	129
102	97.6	119	128	145	131

Weld Check Valve

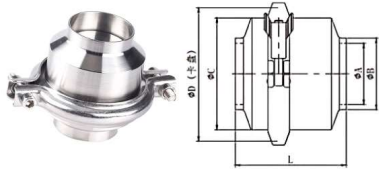

Size	A	B	C	D	L
19	16	19	50.8	64	75
25	22.4	25.4	64	77.5	82.5
32	28.8	31.8	64	77.5	81.5
38	35.1	38.1	64	77.5	81.5
45	42	45	64	77.5	81.5
51	47.8	50.8	75	91	91.5
57	53	57	75.5	91	91.5
63	59.5	63.5	90.5	106	95.5
76	72.2	76.2	104	119	100.5
89	84.9	89	113	130	108
102	97.6	101.6	128	145	110

Thread Check Valve

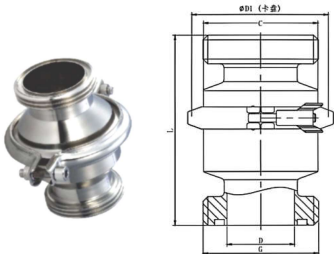

Size	C	D	G	D1	L
19	50.8	16	RD34.5x1/6	64	111
25	64	22.4	RD40x1/6	77.5	112
32	64	28.8	RD48x1/6	77.5	117
38	64	35.1	RD60x1/6	77.5	121
45	64	42	RD60x1/6	77.5	121
51	75	47.8	RD70x1/6	91.0	131
57	75.5	53	RD70x1/6	91	133
63	90.5	59.5	RD85x1/6	106	143
76	104	72.2	RD98x1/6	119	148
89	113	85	RD110x1/6	130	160
102	128	97.6	RD125x1/6	145	160

Diaphragm Valve



Size	D	D1	d	L	H	D2
DN10	25.4	19	9.7	99.5	112	78
DN15	34	19.5	16	108	112	78
DN25	50.5	27	23.6	131	111.5	78
DN32	50.5	34	31	152	117	78
DN40	50.5	43.5	33	163	133.5	94
DN50	64	51.5	48	194	157.5	120

Diaphragm Valve



Size	D	d	C	L	H	H1
DN8	25.4	8	32.5	72	68.5	-
DN15	34	16	64	108	88	110
DN25	50.5	22	89	128	125	150.5
DN32	50.5	29	112	150	141.5	165
DN40	50.5	35	112	180	141.5	169.5
DN50	64	48	139	200	175	210.5
DN65	78	62	158	215	185	235
DN80	106	80	160	243	225	245

Pneumatic Ferrule Butterfly Valve

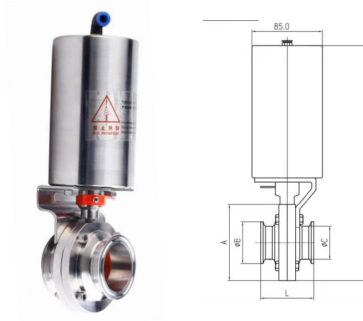

Size	A	B	C	L	H
25	78	50.5	35	64	256
38	78	50.5	38	64	256
50	89	64	51	70	271
76	120	91	76	76	304
101	150	119	106	86	341

3 Way Ball Valve (Small body)

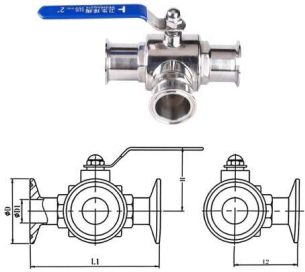

SIZE	D	DI	L	H
19	50.5	17	101	59
25	50.5	22	110.5	51.5
38	50.5	33.5	139	80.5
51	64	48.5	165	88

3 Way Ball Valve (Regular body)

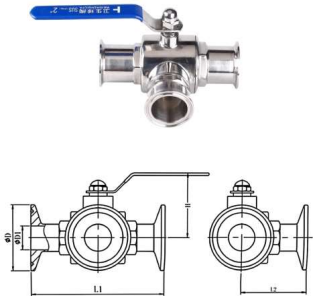

SIZE	D	DI	L	H
19	50.5	15.5	104.5	57
25	50.5	20	127	70.5
38	50.5	34.5	142.6	81.5
51	64	46	173	85.5

Regular Pressure Manhole



SIZE	H1	D1	D2
150	80	155	159
200	80	200	204
219	80	215	219
300	80	296	300
350	80	346	350
400	80	396	400
450	80	446	450
500	80	496	500
600	80	595	600
700	80	695	700

Ball Valve (Small body)

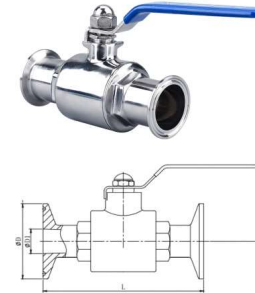

SIZE	D	DI	L	H
19	34	16.5	97.5	54.5
19	50.5	16	97.5	57
25	50.5	23.5	109.5	68.5
38	50.5	34.7	130.5	72.5
51	64	47.5	150.5	81
63	77.5	58.5	168	95.5
76	91	72	186	120
102	119	100	260	143

Ball Valve (Regular body)

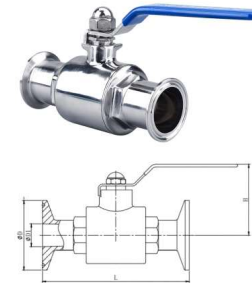

SIZE	D	DI	L	H
19	25.4	12	84	43.5
19	34	17	99.5	59.8
19	50.5	16.8	99.8	50
25	50.5	22.6	117.5	61
38	50.5	34	125.5	70
51	64	47.5	142.1	77.5
63	77.5	53.5	165	90
76	91	73	188	112
102	119	105.5	260	137

Pressure Manhole



SIZE	OD	wall thickness	H	t1	Pre	Handwheel Num
200	206	3	80	4	1-3	4
300	306	3	80	4	1-3	4
350	356	3	80	5	1-3	5
400	406	3	80	6	1-3	6
430	436	3	80	6	1-3	6
450	456	3	80	6	1-3	6
500	508	4	80	6	1-3	6
600	608	4	80	6	1-3	6

3A 90° Weld Elbow

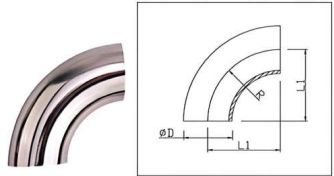

Size	L1	D	R	Thickness
1/2"	19.1	12.7	19.1	1.65
3/4"	28.6	19.1	28.6	1.65
1"	38.1	25.4	38.1	1.65
1 1/4"	47.5	32	47.5	1.65
1 1/2"	57.2	38.1	57.2	1.65
2"	76.2	50.8	76.2	1.65
2 1/2"	95.3	63.5	95.3	1.65
3"	114.3	76.2	114.3	1.65
4"	152.4	101.6	152.4	2
5"	190.5	127	190.5	2
6"	228.6	152.4	228.6	2
8"	304.8	203.2	304.8	2
10"	381	254	381	2
12"	457.2	304.8	457.2	2

3A 45° Weld Elbow

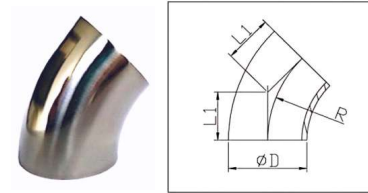

Size	L1	D	R	Thickness
1/2"	7.9	12.7	19.1	1.65
3/4"	11.9	19.1	28.6	1.65
1"	15.8	25.4	38.1	1.65
1 1/4"	19.7	32	47.5	1.65
1 1/2"	23.8	38.1	57.2	1.65
2"	31.8	50.8	76.2	1.65
2 1/2"	39.6	63.5	95.3	1.65
3"	47.6	76.2	114.3	1.65
4"	63.5	101.6	152.4	2
5"	78.9	127	190.5	2
6"	94.7	152.4	228.6	2
8"	127	203.2	304.8	2
10"	158.75	254	381	2

3A 90° Weld Elbow

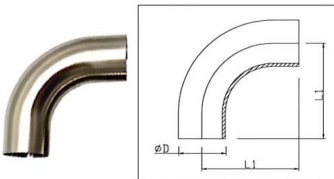

Size	L1	D	R	Thickness
1/2"	76.2	12.7	19.1	1.65
3/4"	76.2	19.1	28.6	1.65
1"	52.34	25.4	38.1	1.65
1 1/2"	74.6	38.1	57.2	1.65
2"	103.2	50.8	76.2	1.65
2 1/2"	131.8	63.5	95.3	1.65
3"	160.3	76.2	114.3	1.65
4"	211.1	101.6	152.4	2
5"	292.1	127	190.5	2
6"	279.4	152.4	228.6	2

3A 45° Weld Long elbow

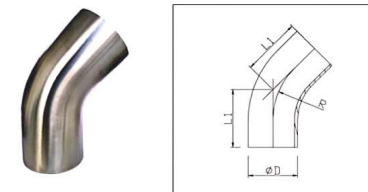

Size	L1	D	R	Thickness
1"	30.2	25.4	38.1	1.65
1 1/2"	41.3	38.1	57.2	1.65
2"	58.7	50.8	76.2	1.65
2 1/2"	76.2	63.5	95.2	1.65
3"	93.7	76.2	95.3	1.65
4"	122.2	101.6	152.4	2
6"	158.2	152.4	228.6	2

3A 90° Ferrule Elbow

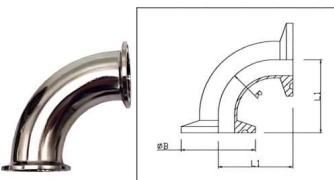

Size	L1	B	R	Thickness
1"	50.8	50.5	38.1	1.65
1 1/2"	69.9	50.5	57.2	1.65
2"	88.9	64	76.2	1.65
2 1/2"	108	77.5	95.3	1.65
3"	127	91	114.3	1.65
4"	168.2	119	152.4	2
5"	212	127	190.5	2
6"	250.8	167	228.6	2

3A 45° Ferrule Elbow

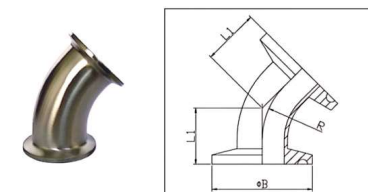

Size	L1	B	R	Thickness
1"	28.5	50.5	38.1	1.65
1 1/2"	36.5	50.5	57.2	1.65
2"	44.5	64	76.2	1.65
2 1/2"	52.3	77.5	95.2	1.65
3"	60.3	91	95.3	1.65
4"	76.2	119	152.4	2

3A 180° Weld Elbow

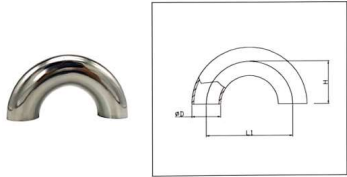

Size	L1	D	H	Thickness
1"	76.2	25.4	38.1	1.65
1 1/2"	114.3	38.1	57.2	1.65
2"	152.4	50.8	76.2	1.65
2 1/2"	190.5	63.5	95.3	1.65
3"	228.6	76.2	114.3	1.65
4"	304.8	101.6	152.4	2

3A Weld Short Tee

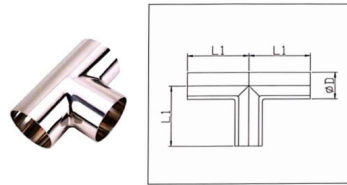

Size	L1	D	Thickness
1/2"	28.6	12.7	1.65
3/4"	28.6	19	1.65
1"	28.6	25.4	1.65
1 1/4"	38	32	1.65
1 1/2"	42	38.1	1.65
2"	52.3	50.8	1.65
2 1/2"	59.5	63.5	1.65
3"	65.9	76.2	1.65
4"	87.3	101.6	2
5"	127	127	2
6"	127	152.4	2

3A Weld Long Tee

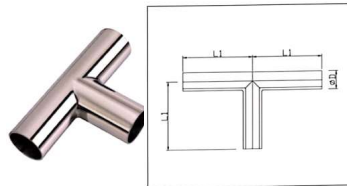

Size	L1	D	Thickness
1/2"	38.1	12.7	1.65
3/4"	38.1	19	1.65
1"	47.6	25.4	1.65
1 1/4"	52.4	32	1.65
1 1/2"	57.2	38.1	1.65
2"	76.2	50.8	1.65
2 1/2"	76.2	63.5	1.65
3"	82.6	76.2	1.65
4"	98.4	101.6	2
5"	132.5	127	2
6"	143	152.4	2
8"	177.8	203.2	2
10"	216	254	2

3A Ferrule Tee

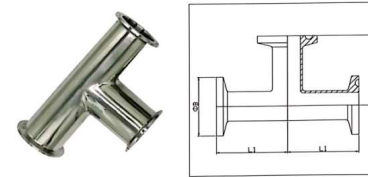

Size	L1	B	Thickness
1/2"	60.3	25.2	1.65
3/4"	60.3	25.2	1.65
1"	60.3	50.5	1.65
1 1/2"	69.9	50.5	1.65
2"	88.9	64	1.65
2 1/2"	88.9	77.5	1.65
3"	95.3	91	1.65
4"	114.2	119	2
5"	164.5	167	2
6"	199.3	217.7	2

3A Weld Long Cross

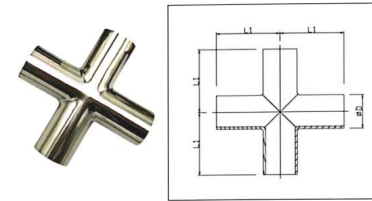

Size	L1	D	Thickness
1/2"	38.1	12.7	1.65
3/4"	38.1	19	1.65
1"	47.6	25.4	1.65
1 1/4"	52.4	32	1.65
1 1/2"	57.2	38.1	1.65
2"	76.2	50.8	1.65
2 1/2"	76.2	63.5	1.65
3"	82.6	76.2	1.65
4"	98.4	101.6	2
5"	132.5	127	2
6"	143	152.4	2
8"	177.8	203.2	2

3A Weld Short cross

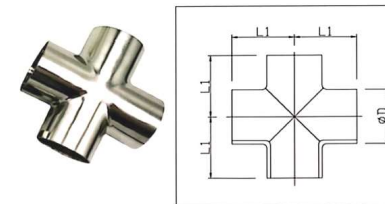

Size	L1	D	Thickness
1/2"	28.6	12.7	1.65
3/4"	28.6	19	1.65
1"	28.6	25.4	1.65
1 1/4"	38	32	1.65
1 1/2"	42.1	38.1	1.65
2"	52.4	50.8	1.65
2 1/2"	54.5	63.5	1.65
3"	65.9	76.2	1.65
4"	87.3	101.6	2
5"	127	127	2
6"	127	152.4	2

3A Ferrule cross

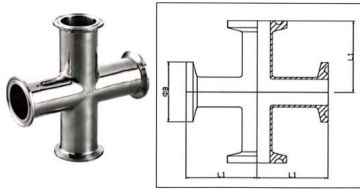

Size	L1	B	Thickness
1/2"	60.3	25.2	1.65
3/4"	60.3	25.2	1.65
1"	60.3	50.5	1.65
1 1/2"	69.9	50.5	1.65
2"	88.9	64	1.65
2 1/2"	88.9	91	1.65
3"	95.3	106	1.65
4"	114.3	119	1.65
6"	164.5	167	2

3A 45° Weld Oblique tee

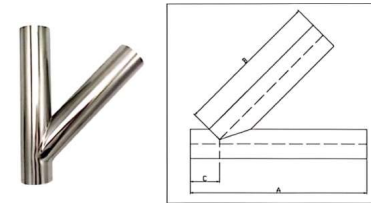

Size	A	B	C	Thickness
1/2"	152.4	127	25.4	1.65
3/4"	152.4	127	25.4	1.65
1"	152.4	127	25.4	1.65
1 1/2"	187.3	173.1	30.2	1.65
2"	222.2	180.9	41.3	1.65
2 1/2"	254	215.9	38.1	1.65
3"	273.1	225.4	47.6	1.65
4"	325.5	273.1	52.4	2
6"	419.1	317.5	101.6	2

3A Weld Ecc/CON Reducer

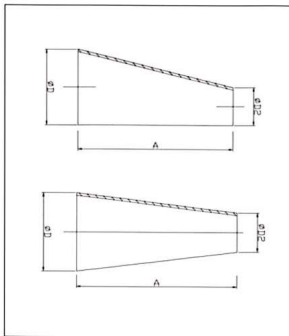
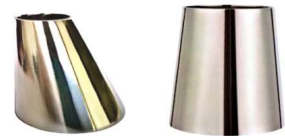

Size	L1	D	D2	Thickness
1" * 1/2"	50.8	25.4	12.7	1.65
1 1/2" * 3/4"	76.2	38.1	19	1.65
1 1/2" * 1"	50.8	38.1	25.4	1.65
2" * 1"	101.6	50.8	25.4	1.65
2" * 1 1/2"	50.8	50.8	38.1	1.65
2 1/2" * 1"	152.4	63.5	25.4	1.65
2 1/2" * 1 1/2"	101.6	63.5	38.1	1.65
2 1/2" * 2"	50.8	63.5	50.8	1.65
3" * 1"	203.2	76.2	25.4	1.65
3" * 1 1/2"	152.4	76.2	38.1	1.65
3" * 2"	101.6	76.2	50.8	1.65
3" * 2 1/2"	50.8	76.2	63.5	1.65
4" * 1"	304.8	101.6	25.4	2
4" * 1 1/2"	254	101.6	38.1	2
4" * 2"	203.2	101.6	50.8	2
4" * 2 1/2"	152.4	101.6	63.5	2
4" * 3"	101.6	101.6	76.2	2
5" * 3"	127	127	76.2	2
5" * 4"	127	127	101.6	2
6" * 2"	140	152.4	50.8	2
6" * 2 1/2"	140	152.4	63.5	2
6" * 3"	140	152.4	76.2	2
6" * 4"	140	152.4	101.6	2
8" * 3"	152.4	203.2	76.2	2
8" * 4"	152.4	203.2	101.6	2
8" * 6"	152.4	203.2	152.4	2
10" * 6"	177.8	254	152.4	2
10" * 8"	177.8	254	203.2	2
12" * 6"	203.2	304.8	152.4	2
12" * 8"	203.2	304.8	203.2	2

3A Weld Y type Tee

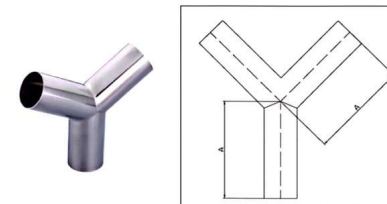

Size	A	Thickness
1/2"	50.8	1.65
3/4"	50.8	1.65
1"	76.2	1.65
1 1/2"	76.2	1.65
2"	101.6	1.65
2 1/2"	127	1.65
3"	152.4	1.65
4"	203.2	2
6"	203.2	2

3A 90° Ferrule Tee

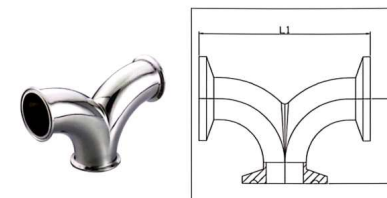

Size	L1	B	Thickness
1"	50.8	101.6	1.65
1 1/4"	60.4	139.7	1.65
1 1/2"	69.85	120.8	1.65
2"	88.9	177.8	1.65
2 1/2"	107.9	215.9	1.65
3"	127	228.6	1.65
4"	168.4	336.8	2

3A Weld Ecc Tee

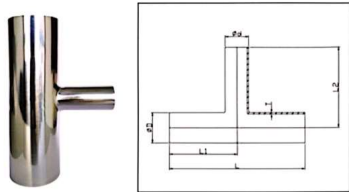

Size	L1	D	d	Thickness
25*19	47.6	25.4	19	1.65
38*19	57.2	38.1	19	1.65
38*25	57.2	38.1	25	1.65
51*25	76.2	50.8	25	1.65
51*38	76.2	50.8	38	1.65
63*25	76.2	63.5	25	1.65
63*38	76.2	63.5	38	1.65
63*51	76.2	63.5	51	1.65
76*25	82.6	76.2	25	1.65
38*76	82.6	76.2	38	1.65
76*51	82.6	76.2	51	1.65
76*63	82.6	76.2	63.5	1.65
102*55	98.4	101.6	55	2
102*57	98.4	101.6	57	2
102*59	98.4	101.6	59	2
102*60	98.4	101.6	60	2
102*63	98.4	101.6	63	2
152*76	143	152.4	76	2
152*102	143	152.4	101	2

DIN 90° Weld short Elbow

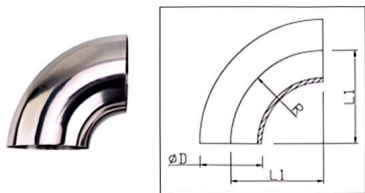

Size	L1	D	R	Thickness
Dn10	26	12	26	1.5
DN15	35	18	35	1.5
DN20	40	22	40	1.5
DN25	50	28	50	1.5
DN32	55	34	55	1.5
DN40	60	40	60	1.5
DN50	70	52	70	1.5
DN65	80	70	80	2
DN80	90	85	90	2
DN100	100	104	100	2
DN125	187	129	187	2
DN150	225	154	225	2
DN200	300	204	300	2
DN250	375	254	375	2
DN300	450	306	450	2

3A Ferrule reducer

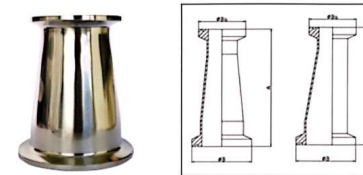

Size	A	B	Ba	Thickness
1 1/2" * 1"	76.2	50.5	50.5	1.65
2" * 1"	127	64	50.5	1.65
2" * 1 1/2"	76.2	64	50.5	1.65
2 1/2" * 1 1/2"	127	77.5	50.5	1.65
2 1/2" * 2"	76.2	77.5	64	1.65
3" * 1 1/2"	177.8	91	50.5	1.65
3" * 2"	127	91	64	1.65
3" * 2 1/2"	76.2	91	77.5	1.65
4" * 2"	231.8	119	64	2
4" * 2 1/2"	181	119	77.5	2
4" * 3"	130.2	119	91	2

DIN 90° Weld long Elbow

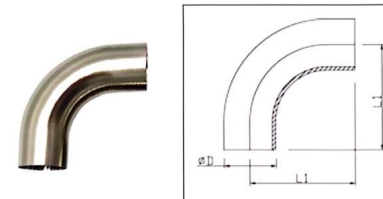

Size	L1	D	R	Thickness
DN10	38	12	26	1.5
DN15	47	18	35	1.5
DN20	52	22	40	1.5
DN25	70	28	50	1.5
DN32	78	34	55	1.5
DN40	85	40	60	1.5
DN50	79	52	70	1.5
DN65	110	70	80	2
DN80	118	85	90	2
DN100	140	104	100	2

DIN 45° Weld Elbow

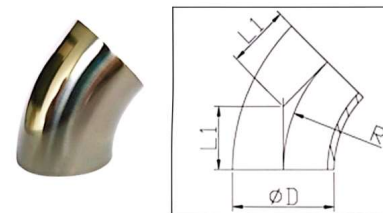

Size	L1	D	R	Thickness
Dn10	10.7	12	36	1.5
DN15	14.5	18	35	1.5
DN20	16.5	22	40	1.5
DN25	20.7	28	50	1.5
DN32	22.8	34	55	1.5
DN40	24.8	40	60	1.5
DN50	29	52	70	1.5
DN65	33.2	70	80	2
DN80	37.3	85	90	2
DN100	41.5	104	100	2
DN125	77.5	129	187	2
DN150	93.5	154	225	2

DIN 180° Weld Elbow

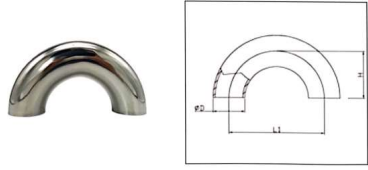

Size	L1	D	H	Thickness
DN10	52	12	26	1.5
DN15	70	18	35	1.5
DN20	80	22	40	1.5
DN25	100	28	50	1.5
DN32	110	34	55	1.5
DN40	120	40	60	1.5
DN50	140	52	70	1.5
DN65	160	70	80	2
DN80	180	85	90	2
DN100	200	104	100	2
DN125	375	129	187.5	2
DN150	450	154	225	2

DIN Weld Flat Tee

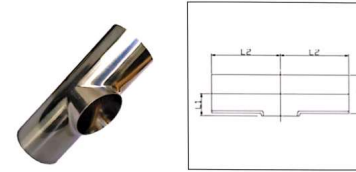

Size	L1	D	H	Thickness
DN10	7.5	26	12	1.5
DN15	10.5	35	18	1.5
DN20	12.5	40	22	1.5
DN25	16	50	28	1.5
DN32	19.5	55	34	1.5
DN40	22.5	60	40	1.5
DN50	30	70	52	1.5
DN65	39.5	80	70	2
DN80	47.5	90	85	2
DN100	58	100	104	2
DN125	70.5	187	129	2
DN150	83	225	154	2
DN200	-	300	204	2

DIN Weld Reducer

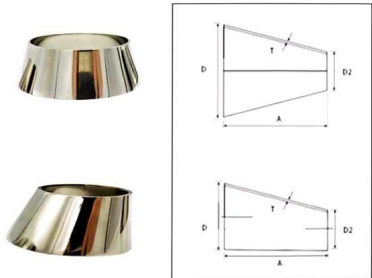

Size	A	D	D2	Thickness
DN20/15	7	22	18	1.5
DN25/20	11	28	22	1.5
DN32/20	22	34	22	1.5
DN32/25	11	34	28	1.5
DN40/20	33	40	22	1.5
DN40/25	22	40	28	1.5
DN40/32	11	40	34	1.5
DN50/25	44	52	28	1.5
DN50/32	33	52	34	2
DN50/40	22	52	40	2
DN65/25	73	70	28	2
DN65/32	62	70	34	2
DN65/40	51	70	40	2
DN65/50	29	70	52	2
DN80/40	78	85	40	2
DN80/50	56	85	52	2
DN80/65	27	85	70	2
DN100/50	90	104	52	2
DN100/65	61	104	70	2
DN100/80	34	104	85	2

DIN Weld Tee

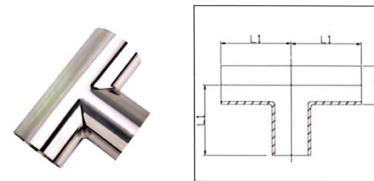

Size	L1	D	Thickness
DN10	26	12	1.5
DN15	35	18	1.5
DN20	40	22	1.5
DN25	50	28	1.5
DN32	55	34	1.5
DN40	60	40	1.5
DN50	70	52	1.5
DN65	80	70	2
DN80	90	85	2
DN100	100	104	2
DN125	187	129	2
DN150	225	154	2
DN200	300	204	2

DIN ISO Ferrule Tee

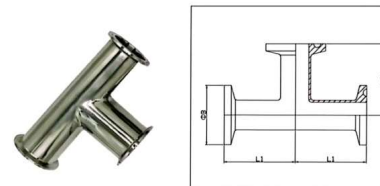

Size	L1	D	Thickness
1"	55	50.5	1.5
1 1/4"	59.5	50.5	1.5
1 1/2"	70	50.5	1.5
2"	82	64.0	1.5
2 1/2"	105	77.5	1.5
3"	110	91.0	1.5
3 1/2"	125	106	2.0
4"	148.5	119.0	2.0

DIN Weld Cross

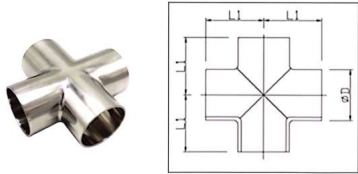

Size	L1	D	Thickness
DN10	26	12	1.5
DN15	35	18	1.5
DN20	40	22	1.5
DN25	50	28	1.5
DN32	55	34	1.5
DN40	60	40	1.5
DN50	70	52	1.5
DN65	80	70	2
DN80	90	85	2
DN100	100	104	2
DN125	187	129	2
DN150	225	154	2
DN200	300	204	2

ISO 90° Weld Elbow

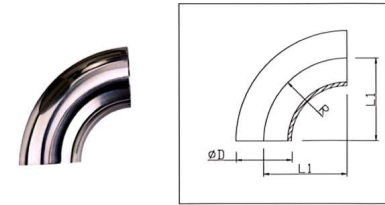

Size	L1	D	R	Thickness
25.4	33.5	25.4	33.5	1.5
32	38	32	38	1.5
38.1	48.5	38.1	48.5	1.5
42	48	42	48	1.5
45	55.5	45	55.5	1.5
48	57	48	57	1.5
50.8	60.5	50.8	60.5	1.5
57	74	57	74	1.5
60	76	60	76	1.5
63.5	83.5	63.5	83.5	1.65
76.2	88.5	76.2	88.5	1.65
89	103.5	89	103.5	2
101.6	127	101.6	127	2
114.3	152.4	114.3	152.4	2
133	190.5	133	190.5	2
159	228.6	159	228.6	2

ISO Ferrule Elbow

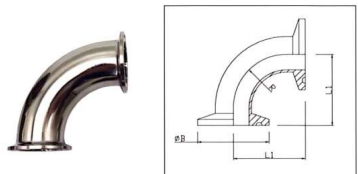

Size	L1	D	R	Thickness
25	55	50.5	33.5	1.5
32	59.5	50.5	38	1.5
38	70	50.5	48.5	1.5
51	82	64	60.5	1.5
63	105	77.5	83.5	1.5
76	110	91	88.5	1.5
89	125	106	103.5	1.5
102	143.5	119	122	2
102	148.5	119	129	2

ISO 45° Ferrule Elbow

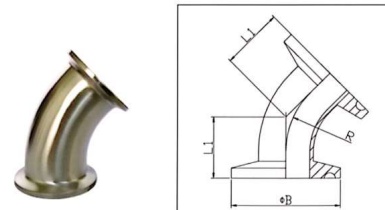

Size	L1	D	R	Thickness
25	35.4	50.5	33.5	1.5
32	37.2	50.5	38	1.5
38	41.6	50.5	48.5	1.5
51	46.6	64	60.5	1.5
63	56.1	77.5	83.5	1.5
76	58.2	91	88.5	1.5
89	64.4	106	103.5	1.5
102	72.3	119	122	2
102	80.5	119	127	2

ISO 45° Weld Elbow

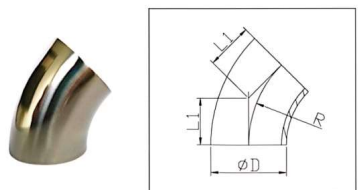

Size	L1	D	R	Thickness
25.4	13.9	25.4	33.5	1.5
32	15.7	32	38,0	1.5
38.1	20.1	38.1	48.5	1.5
50.8	25.1	50.8	60.5	2
63.5	34.6	63.5	83.5	2
76.2	36.7	76.2	88.5	2
89	42.9	89	103.5	2
101.6	50.8	101.6	122	2
101.6	52.6	101.6	127	2

ISO Weld Cross

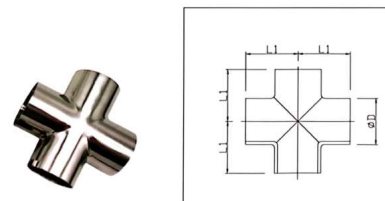

Size	L1	D	Thickness
1"	33.5	25.4	1.5
1 1/4"	38	32	1.5
1 1/2"	48.5	38	1.5
2"	60.5	51	2
2 1/2"	83.5	63.5	2
3"	88.5	76	2
3 1/2"	103.5	89	2
4"	127	101.6	2

ISO Weld Tee

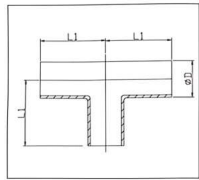

Size	L1	D	Thickness
1/2"	38.2	25.4	1.5
3/4"	60	25.4	1.5
1"	33.5	25.4	1.5
1 1/4"	38.1	31.8	1.5
1 1/2"	48.5	38.1	1.5
2"	60.5	50.8	2
2 1/2"	83.5	63.5	2
3"	88.5	76.2	2
3 1/2"	103.5	88.9	2
4"	127	101.6	2
4 1/2"	152.4	114.3	2
5"	190	133	2
6"	228.6	159	2

SMS Weld Tee

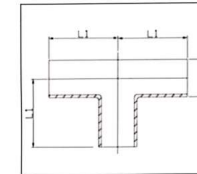

Size	L1	D	Thickness
12.7	55	12.7	1.5
19	55	19	1.5
25	55	25.4	1.5
32	62.5	32	1.5
38	70	38.1	1.5
51	82	50.8	1.5
63	105	63.5	1.5
76	110	76.2	1.5
102	150	101.6	1.5
127	150	127	2
152	150	152.4	2
203	180	203.2	2

ISO Weld Reducer

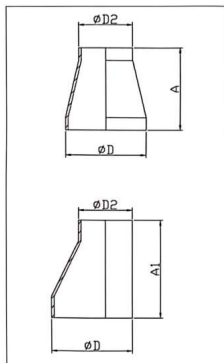

Size	A	D	D2	Thickness
1" * 3/4"	38	25.4	19.05	1.5
1 1/4" * 1"	50	31.8	25.4	1.5
1 1/2" * 1 1/4"	50	38.1	31.8	1.5
1 1/2" * 1"	50	38.1	25.4	1.5
2" * 1 1/2"	67.0	50.8	38.1	1.5
2" * 1 1/4"	67	50.8	31.8	1.5
2" * 1"	67	50.8	25.4	1.5
2 1/2" * 2"	67	63.5	50.8	1.5
2 1/2" * 1 1/2"	67	63.5	38.1	1.5
2 1/2" * 1"	67	63.5	25.4	1.5
3" * 2 1/2"	67	76.2	63.5	1.5
3" * 2"	67	76.2	50.8	1.5
3" * 1 1/2"	67	76.2	38.1	1.5
3 1/2" * 3"	76	88.9	76.2	1.5
3 1/2" * 2 1/2"	67	88.9	63.5	1.5
3 1/2" * 2"	67	88.9	50.8	1.5
4" * 3 1/2"	87	101.6	88.9	2.0
4" * 3"	87.0	101.6	76.2	2.0
4" * 2 1/2"	87	101.6	63.5	2
4" * 2"	87.0	101.6	50.8	2.0

SMS Weld Straight side long Reducer

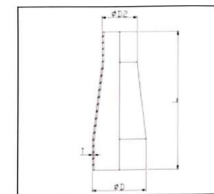

Size	A	D	D2	Thickness
25 × 19	25	19.05	85	1.5
38 × 19	38.0	19.05	85	1.5
38 × 25	38.0	25	99	1.5
51 × 25	51.0	25	117	1.5
51 × 38	51.0	38	99	1.5
63.5 × 25	63.5	25	134	1.5
63.5 × 38	63.5	38	117	1.5
63.5 × 51	63.5	51	99	1.5
76.1 × 25	76.1	25	152	1.65
76.1 × 38	76.1	38	134	1.65
76.1 × 51	76.1	51	117	1.65
76.1 × 63	76.1	63	99	1.65
101.6 × 51	101.6	51	155	2
101.6 × 63	101.6	63.5	138	2
101.6 × 76	101.6	76.1	120	2

SMS Weld Flat Cross

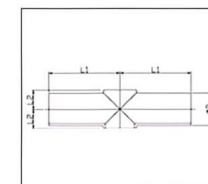

Size	A	D	D2	Thickness
25	55	15	25.4	1.5
38	70	21.5	38.1	1.5
51	82	29	50.8	1.5
63.5	105	36	63.5	1.5
76.2	110	43	76.2	1.5
102	150	57	101.6	1.5

SMS Weld ECC/CON Reducer



Size	A	A1	P	D2	Thickness
1 1/2" x 1"	390	45	38.1	25.4	1.5
2" x 1"	57	68	50.8	25.4	1.5
2" x 1 1/2"	39	47	50.8	38.1	1.5
2 1/2" x 1"	74	92	63.5	25.4	1.5
2 1/2" x 1 1/2"	57	70	63.5	38.1	1.5
2 1/2" x 2"	39	44	63.5	50.8	1.5
3" x 1"	92	117	76.2	25.4	1.5
3" x 1 1/2"	74	92	76.2	38.1	1.5
3" x 2"	57	68	76.2	50.8	1.5
3" x 2 1/2"	39	47	76.2	63.5	1.5
4" x 1 1/2"	112	47	101.6	38.1	1.5
4" x 2"	95	117	101.6	50.8	1.5
4" x 2 1/2"	78	94	101.6	63.5	1.5
4" x 3"	60	740	101.6	76.2	1.5

SMS Weld ECC Tee

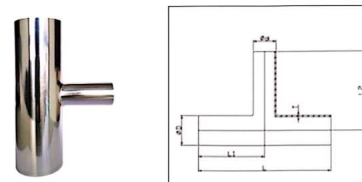

Size	L	L1	D	d	Thickness
25 x 19	110	55	25	19.05	1.5
38 x 19	140	70	38	19.05	1.5
38 x 25	140	70	38	25	1.5
51 x 25	164	82	51	25	1.5
51 x 38	164	82	51	38	1.5
63.5 x 25	210	105	63.5	25	1.5
63.5 x 38	210	105	63.5	38	1.5
63.5 x 51	210	105	63.5	51	1.5
76.1 x 25	220	110	76.1	25	1.5
76.1 x 38	220	110	76.1	38	1.5
76.1 x 51	220	110	76.1	51	1.5
76.1 x 63	220	110	76.1	63	1.5
101.6 x 51	300	150	101.6	51	2.0
101.6 x 63	300	150	101.6	63.5	2.0
101.6 x 76	300	150	101.6	76.1	2.0

SMS Weld Flat Tee

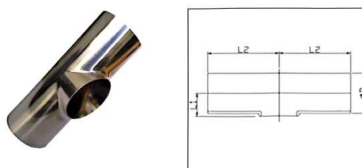

Size	L1	L2	D	Thickness
25	15	55	25.4	1.5
38	21.5	70	38.1	1.5
51	29	82	50.8	1.5
63	36	105	63.5	1.5
76	43	110	76.2	1.5
102	57	150	101.6	1.5

SMS 90° Weld Elbow

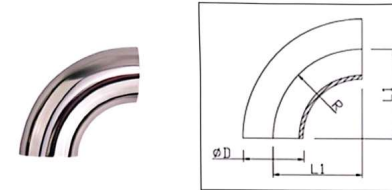

Size	L1	D	R	Thickness
12.7	19.05	12.7	19.05	1.5
19	28.6	19	28.6	1.5
25	38.1	25.4	38.1	1.5
32	47.7	31.8	47.7	1.5
38	57.1	38.1	57.1	1.5
51	76.2	50.8	76.2	1.5
63	95.2	63.5	95.2	1.5
76	114.3	76.2	114.3	1.5
102	152.4	101.6	152.4	1.5
127	190.5	127	190.5	2
152	228.6	152.4	228.6	2

SMS 90° Weld Long Elbow

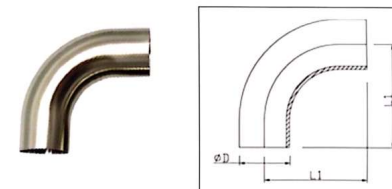

Size	L1	D	R	Thickness
25	55	25.4	32	1.5
38	70	38.1	45	1.5
51	82	50.8	58	1.5
63	105	63.5	70	1.5
76	110	76.2	76	1.5
102	150	101.6	110.0	1.5

SMS 45° Weld Elbow

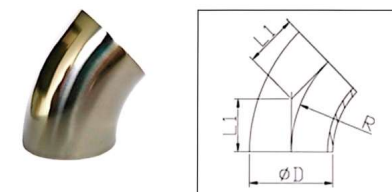

Size	L1	D	R	Thickness
25	15.5	25.4	38.1	1.5
38	23.6	38.1	57.2	1.5
51	31.6	50.8	76.2	1.5
63	39.5	63.5	95.3	1.5
76	47.2	76.2	114.3	1.5
102	63	101.6	152.4	1.5

SMS 45° Weld Long Elbow

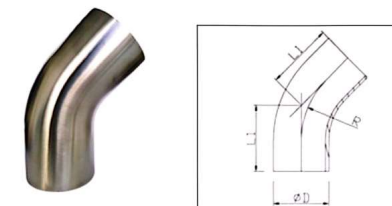

Size	L1	D	R	Thickness
25	2.5	25.4	38.7	1.5
38	56.8	38.1	57.2	1.5
51	68.6	50.8	76.2	1.5
63	78.4	63.5	95.2	1.5
76	85.2	76.2	114.3	1.5
102	103	101.6	152.4	1.5



1 PC Ball Valve 2 PC Ball Valve 3 PC Ball Valve Tee Ball Valve Flang 3 PC Ball Valve



Double Clip Type Flange Ball Valve Tap Ball Valve Wafer Check Valve Drain Valve Flange



Gate Valve Globe Valve Vertical Check Valve Horizontal Check Valve Y Type Strainer



Wafer Butterfly Valve Angle Seat Valve Pneumatic Tee Ball Valve Flange Ball Valve Flange Globe Valve



Elbow Tee Reducer Hex Nipple Hex Hose Nipple



Female Elbow Female Tee Female Cross Female Union Male End Cap



Bushing Female Reducer Female pipe Hex Female Cap Female Pipe Cap



Female Pipe Single Male Pipe Hose Male Pipe Coupling Quick Coupling